

High Productivity, High Performance

The ECOSYS PA6000x delivers an exceptional high-speed printing of up to 60 pages per minute and a first print time of 4.5 seconds, guaranteeing efficient and reliable operation in a vibrant professional work environment. The low level of total cost of ownership and intelligent security features provide more than you expect.

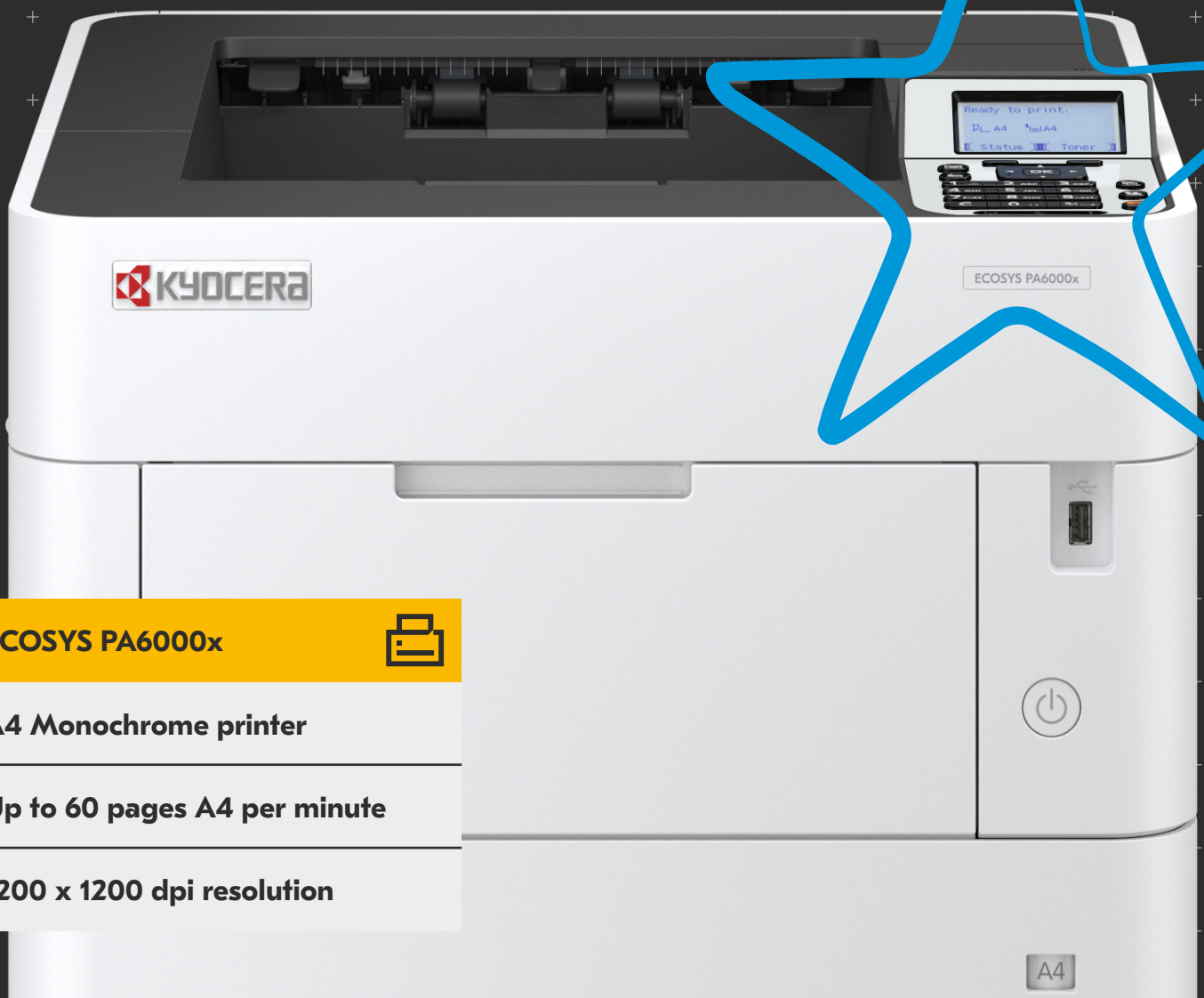

ECOSYS PA6000x



A4 Monochrome printer

Up to 60 pages A4 per minute

1200 x 1200 dpi resolution

A4

Specifications

GENERAL

KYOCERA ECOSYS Laser Monochrome Printer
Operation panel: LCD 21 characters, 5 lines
Type: Desktop
Engine speed: Up to 60 pages A4 per minute;
Duplex print speed: 43 page per minute, A4.
Resolution: 1,200 x 1,200 dpi
Recommended Average Print Volume: 30,000 pages per month.
Maximum Life: 1,000,000 pages or 5 years.
Warm-up time: Approx. 25 seconds or less.
Time to first print: Approx. 4.5 seconds or less.
CPU: ARM Cortex-A53 Dual core 1.4GHz
Memory: Standard 512MB; Max. 2.5GB (optional) Standard interfaces: Standard interface: USB 2.0 (Hi-Speed), 2 x USB Host Interface, Gigabit Ethernet (10BaseT/100BaseTX/1000BaseT), optional Wireless LAN (IEEE 802.11b/g/n), 2 eSATA slots for optional internal print server or SSD hard disc, Slot for optional SD/SDHC Card.
Integrated accounting: 100 department codes.
Dimensions (W x D x H): Without packaging: 403 x 410 x 320 mm (without protrusions); 410 x 416 x 363 mm (with protrusions); With packaging: 549 x 517 x 455 mm
Weight: Approx. 16.2kg with bundled toner
With packaging: 20 kg
Power source: AC 220 ~ 240 V, 50/60 Hz
Power consumption: Printing: 710.2 W
Ready mode: 9 W
Sleep-mode: 0.5 W
Noise (sound pressure level: ISO 7779/ISO 9296): Printing: 57 dB (A)
Stand-by: 33 dB (A)
Safety standards: TÜVGS, CE
This unit is manufactured according to ISO 9001 quality standard and ISO 14001 environmental standard.

PAPER HANDLING

All paper capacities quoted are based on paper thickness of max. 0.11 mm. Please use paper recommended by KYOCERA under normal environmental conditions.
Input capacity: Multi-purpose tray: 100 sheets, 60 to 220 g/m², A4, A5, B5, Letter, Legal, Folio, Custom (140 x 210 to 216 x 356 mm), Banner paper up to 915 mm.
Standard universal paper cassette: 500 sheet, 60–120 g/m², A4, A5, B5, Letter, Legal, Folio, Custom (140 x 210 to 216 x 356 mm).
Max. input capacity with options: 2,600 sheets.
Duplex: Standard duplex unit, 60 to 120 g/m², A4, A5, B5, Letter, Legal, Custom (140x 210 mm - 216 x 356 mm).
Output capacity: 500-sheet-face-down with paper full sensor and optional 250-sheet-face-up with PT-320

PRINT FUNCTIONS

Controller language: PRESCRIBE
Emulations: PCL6 (5 c/XL), KPDL3 (PostScript 3 compatible), PDF Direct Print, XPS Direct Print and Open XPS, PPML, TIFF/JPEG Direct Print Support, URF, PWG Raster, PCLm, IBM Proprinter, Line Printer, Epson LQ-850.
Operating systems: All current Windows operating systems, MAC OS X Version 10.9 or higher, Chrome OS, Linux, as well as other operating systems on request.
Fonts/barcodes: 93 outline fonts (PCL6, KPDL3), 4 fonts (Calibri), 4 fonts (Cambria), 1 Bitmap font, 45 types of one-dimensional barcodes, 1 type of two-dimensional barcode (PDF417).
Print features: PDF Direct Print, Internet printing IPP 1.0, E-mail printing, WSD print, secure printing IPP over TLS, Local and network authentication, Network data encryption IPsec, HTTPS, LDAP over TLS, SNMPv3, SMTP over TLS, POP over TLS, Encrypted PDF Direct Print, Universal Print, Printing for Chrome OS.
Mobile printing support: KYOCERA Mobile Print app for iOS and Android, AirPrint, Mopria, Wi-Fi Direct.

CONSUMABLES

Average continuous toner yield in accordance with ISO/IEC 19752.
TK-344 4 Toner Kit:
Microfine toner black for 40,000 pages A4.
Capacity of starter toner is 11,000 pages A4.

OPTIONS

PF-3110 Paper feeder (max. 4 units): Max. 500 sheets, 60 - 120 g/m²; A4, A5, B5, Letter, Legal, Custom (92 x 162 mm - 216 x 356 mm)
PF-3100 Bulk paper feeder and PB-325 Printer base: Max. 2,000 sheets, 60 - 220 g/m²; A4, A5, B5, Letter, Custom (76 x 148 to 216 x 305 mm); not to be combined with PF-3110
PT-320 Paper tray: 250-sheet face-up output tray
CB-360W Cabinet: High Cabinet for 2 draw configuration, Approx. 380 x 411 x 508 mm (WxDxH)
CB-365W Cabinet: Low cabinet for 4 draw configuration, Approx. 380 x 411 x 254 mm (WxDxH)
CA-3100 Caster Unit: for increased stability. Mandatory when installing 4 optional paper feeders.
Memory upgrade: MM-2.0 (1GB)/MM-2.1 (2GB)
Storage Devices for easy document management:
HD-17 SSD hard disk: 64GB
HD-18 SSD hard disk: 256GB
HD-19 SSD hard disk: 512GB

SECURITY

UG-33 AC: ThinPrint support
UG-50: TPM (Trusted Platform Module)
USB IC Card Reader + Card Authentication Kit (B) AC: Support for various authentication keys available.
CRH 10: IC card Reader Holder
Optional interface:
IB-32 B: IEEE1284 interface
IB-37: Wireless LAN (802.11b/g/n) with Wi-Fi Direct
IB-50: Gigabit-Ethernet board 10 BaseT/100 BaseTX/1,000 BaseT
IB-51: Wireless LAN Interface (802.11b/g/n)

WARRANTY

2 years on-site as standard.

WHAT'S IN THE BOX:

Main unit, pre-installed starter toner, waste toner box, user documents, power supply cord.

ECOSYS stands for ECOlogy, ECONomy and SYStem printing. With their long-life components, ECOSYS devices are designed to maximise durability and minimise the total cost of ownership with regard to maintenance, administration and consumables. The cartridge-free system means that only the toner has to be replaced regularly. The modular design concept allows you to add workflowenhancing functions as required. Integrated system software provides long-term crossnetwork compatibility. KYOCERA's long-life components cost you and the environment less.



Printzone.
1300 782 636

KYOCERA Document Solutions Partner

MAR CH20 23ECO SYSPA6000x/VER1.0

KYOCERA Document Solutions Australia
Ph: 13 59 62
www.kyoceradocumentsolutions.com.au

KYOCERA Document Solutions New Zealand
Ph: 0800 459 623
www.kyoceradocumentsolutions.co.nz

